

Redmond Downtown Park



The park will serve everyday uses for the Downtown neighborhood, as well as provide space for special cultural events and performances for the entire community.

- Location:** 16101 Redmond Way, between Redmond Way and Cleveland Street (bordered by 161st Ave NE on the west and The Stone House Restaurant on the east).
- Project Phase:** In Design
- Estimated Timeline:** Construction 2016 - 2018. Park opens 2018
- Contact:** B Sanders, Senior Park Planner, 425-556-2328

Every great city has a signature place that serves as a destination, an icon for the city, and a catalyst for economic growth. The Downtown Park will be Redmond's signature park, and will create a place for community members to gather and celebrate. It will be a vibrant community space that encourages special events, arts, music and fun. The enhanced pedestrian environment in and around the park will stimulate economic activity in the neighborhood.

- A** Raised lawn, deck and trees—Play, meet friends and people watch
- B** Fountains of water jets—Fun for the kids!
- C** Pavilion with digital art on water wall—Watch digital art, dance, and sip coffee under shelter from sun and rain
- D** Gardens and trees—Relax in the greenery
- E** Plaza—Enjoy performances, festivals and events
- F** Dining grove—Bring a bite to eat under the trees
- G** Restrooms and drinking fountain

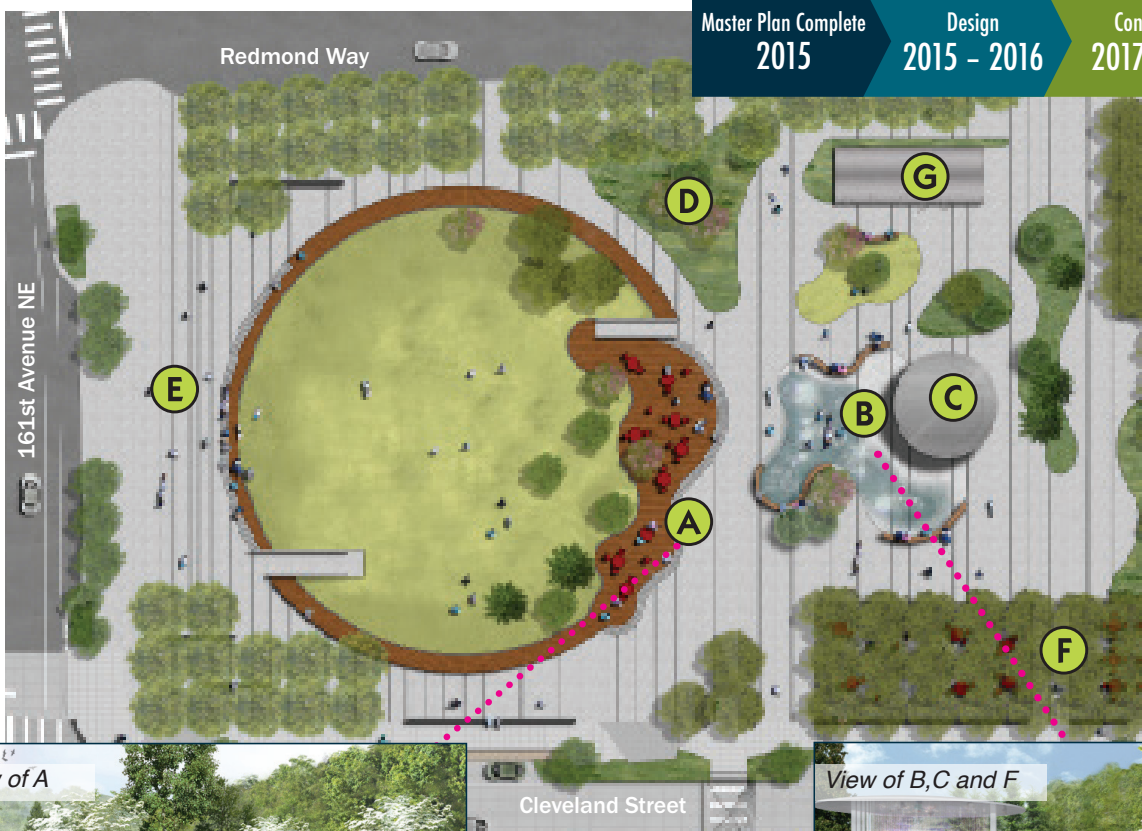

More details at redmond.gov/DowntownPark

Project Status:

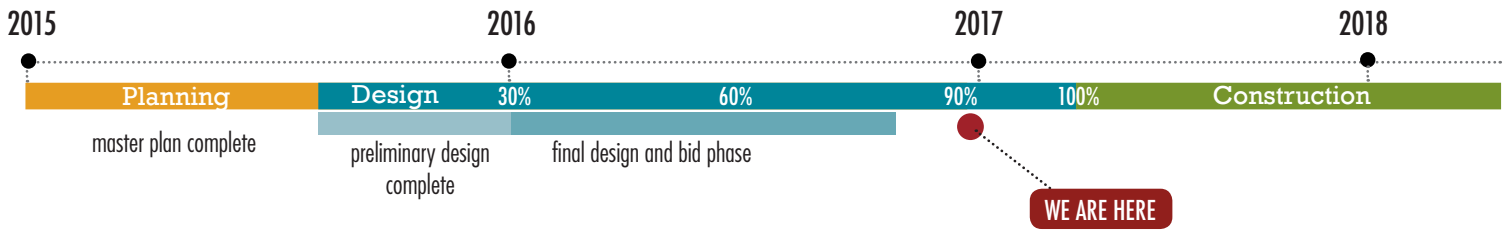

Project Costs:

Total:	\$39.7 million
City General Funds:	\$ 5.8 million
Other Funding:	\$33.9 million

Recent Activities:

- Final design is progressing and the project is moving through the permit process.
- Council approved the peat removal contract July 5, 2016. The peat removal started in August and was completed in October.

What's Happening Next:

- The park site closed to the public late August, 2016 as construction activities at the site began, starting with earthwork to remove unsuitable soils. The earthwork was completed in fall 2016, and the main park construction will begin in early 2017. The soil at the site was replaced with materials that will provide structural support and infiltration for site rainwater when the drainage system is installed.
- A portion of the park site along Redmond Way is being used for storage of equipment or materials for the Two-way Street Conversion project.
- The park site will remain closed until the new Downtown Park opens in 2018.
- A contract will be taken to City Council on December 6, 2016 to authorize contract approval for fabrication of the art pavilion.
- The bid period for the main construction is anticipated to be advertised starting in January 2017.

Neighborhood Impacts:

- Traffic impacts from the park site, which is being used for storage of Two-Way Street Conversion construction materials.
- Possible construction noise during the day. Trucks will be traveling to and from the park site moving materials for the Two-way Street Conversion.



Get Involved:

Support of Downtown Businesses

We Dig Downtown After Party: Discounts at Downtown businesses with your Redmond Lights blinker the weekend of Dec 3-4

Phase II of We Dig Downtown rolls out in December: Patrons are encouraged to Eat, Sip, Shop Downtown and then Snap and Share with #WeDigDowntown hashtag to participate in prize drawings.

redmond.gov/downtown



Related News:

Sign up for traffic alerts and get the latest project updates at redmond.gov/enews. Just make sure to select "Downtown Projects Updates" from the news list.

Document Last Updated November 2016